

INSTRUCTIONS FOR ANNUAL SELF INSPECTION

Before you start self inspection print this document

1) Carefully read all instructions below - in cases of any uncertainty about maintaining or servicing your inflatable PFD it is recommended that an enhanced certified annual inspection is performed by one of our accredited service agents. These self service instructions are applicable for Burke Inflatable PFD's in recreational use only, for PFD's in commercial use inspections should only be performed by an accredited service agent.

2) During the inspection the green firing indicator located on the side of the CO2 inflation mechanism will be broken, ensure you have some before starting. You may also need to replace CO2 cylinders and automatic cartridge/bobbins. All these parts can be purchased through a Burke retailer or service agent.

3) Use the 'Inflatable PFD self inspection certificate' to record each inspection step as it is completed.

NOTE: If your PFD or a component of your PFD fails any of the inspection steps 1 - 6 described below the PFD must be replaced or the faulty component replaced before further use. Alternatively the PFD can be sent to an accredited service station for further tests.

Under no circumstances must you attempt any repairs, these must only be conducted by trained service personnel.

Step 1. General inspection

1.1 Check

- a) life jacket cover has no wear or damage
- b) cover closures are serviceable (hook and loop or zipper as applicable)
- c) straps have no visible damage.
- d) correct operation of buckle (Open and close buckle.)

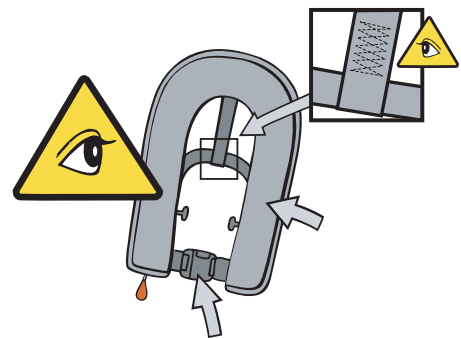

1.2 Open cover and check

- a) retro-reflective tape is firmly attached and not damaged,
- b) lifting becket has no visible damage,
- c) whistle (blow to check operation)
- d) oral inflation tube has no visible damage

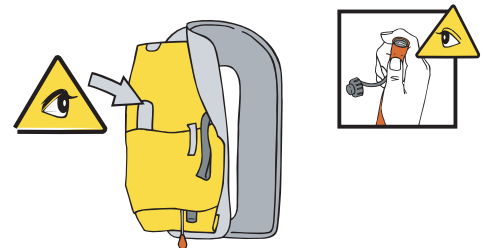

1.3 For models fitted with integral safety harness check that all harness components have no visible damage or excessive wear. Check

- a) stitching
- b) buckles
- c) safety lanyard attachment ring
- d) webbing

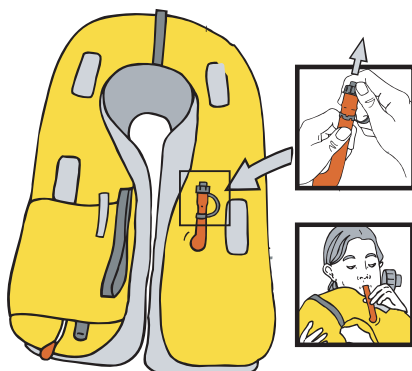

Step 2. Inspection of lung

2.1 Open cover and inspect lung has no signs of excessive abrasion or wear. Pay extra attention to folds and area around inflation systems.

2.2. Inflate lung by using red oral tube. Leave the inflated PFD 12hrs in a room with stable temperature of around 20°C. If temperature goes down overnight, this will affect pressure. Check there is no loss of pressure and no visible damage to the lung.

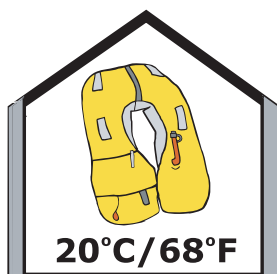
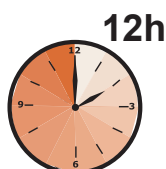
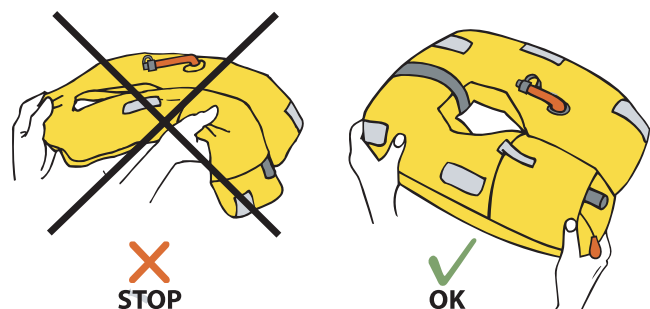

If the lung is damaged or the pressure falls, the PFD must be replaced or sent to an accredited service station for further tests. Under no circumstances must you attempt to repair the PFD.

Step 3. Inspection of mouth inflation tube and its valve

3.1 Check mouth inflation tube and valve operate correctly. Deflate the life jacket by inverting the cap and placing the tab onto the top of the mouth inflation tube. Press cap gently to expel air. When the PFD is fully deflated replace cap to normal position. Do not put anything other than the inverted cap down the oral inflation tube to deflate as foreign objects may damage the valve.

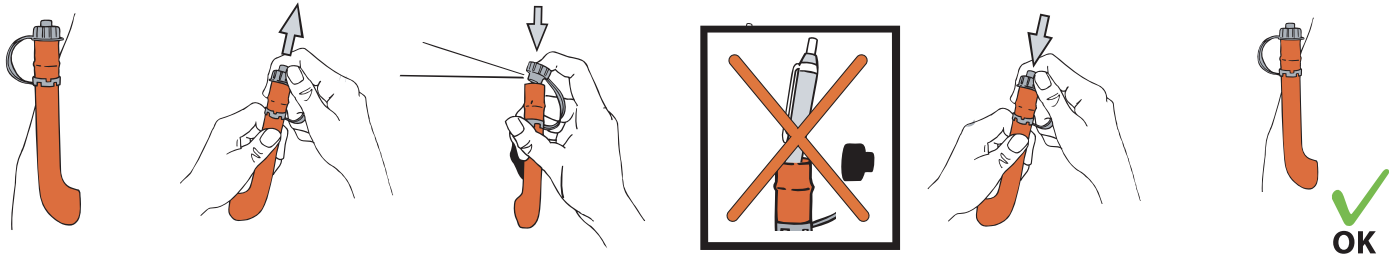

Step 4. Inspection of CO2 cylinder

4.1 Check that correct type / size of CO2 cylinder is fitted to the inflation valve (printed on the lung near inflation valve or the cylinder / inflation valve protective cover). Remove the CO2 cylinder by unscrewing it anti-clockwise and inspect thoroughly. It should be intact with no rust or corrosion. Replace the cylinder if the end cap has been pierced, it is damaged or the cylinder exhibits signs of rust or corrosion.

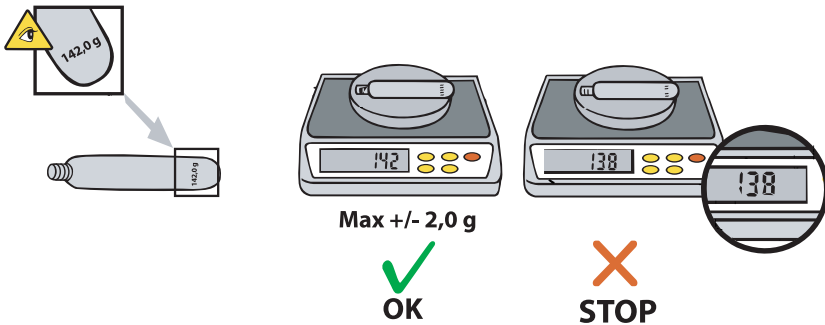
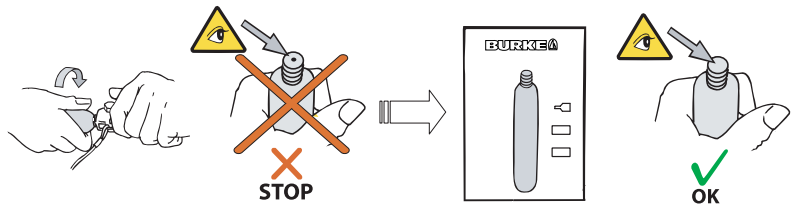

4.2 If the CO2 cylinder is serviceable (Refer 4.1) Check weigh the cylinder on a kitchen or letter scales to ensure that the weight of the cylinder corresponds to the min. gross weight engraved on the cylinder, (GR.WT) +/- 2 g. If the weight is incorrect or the cylinder is in any way defective it must be replaced. (A replacement cylinder should also be checked in the same manner.) Record engraved GR.WT. and actual weight of cylinder on your self inspection certificate.

NB! Make sure that all scraped CO2 cylinders are disposed of at once!

DO NOT REFIT THE CO2 CYLINDER YET

Step 5. Examine Operation of Manual Valve

5.1 With the CO2 cylinder removed (refer step # 4) pull the manual lanyard sharply to ensure that the lever moves freely, and that the piercing cutter becomes proud of the CO2 sealing washer at the base of the thread inside the inflator body. If the lever moves freely and piercing cutter becomes proud, rearm the valve by folding back the lever into normal position and securing with a new green firing indicator clip. If the valve does not operate properly, the PFD must be replaced or sent to an accredited service station for further action.

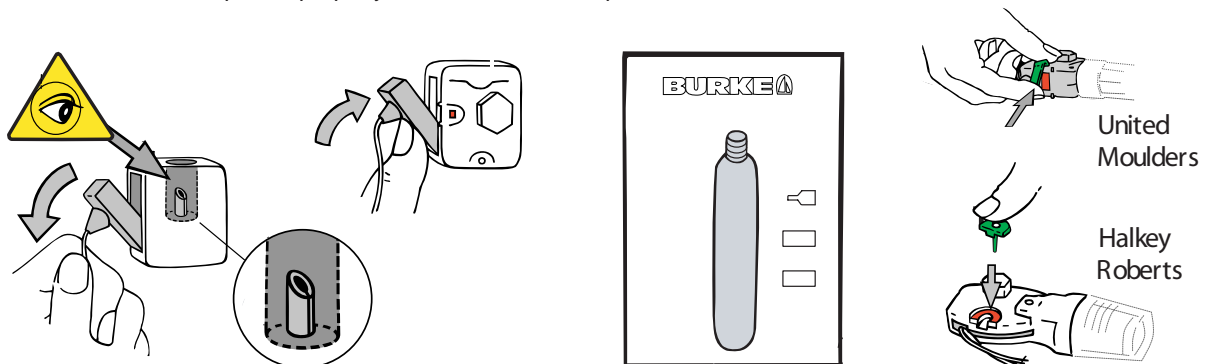

Step 6. Inspection and rearming of automatic valve (automatic models only)

Cartridge or Bobbin (as applicable) must be replaced if it has been immersed in water, is past its expiry date or if the expiry date falls before PFD's next scheduled service

6.1 For Automatic models fitted with United Molders automatic valve with water sensing cartridge (Fig 1.)

UML cartridge has a 3 lifespan and is printed with an expiry date

- Unscrew the cartridge anti clockwise,
- Check that the cartridge is clean and completely dry,
- Record the expiry date printed on the cartridge on the inspection certificate and check that the green indicator is in place. Discard and replace cartridge if expiry date falls within next 12 months or green indicator at base of cartridge is not visible.
- Rearm by screwing cartridge clockwise onto base of inflator head. Ensure thread is not obstructed and tighten firmly using light hand force only. Ensure that the green auto firing indicator (at base of cartridge) is present on any auto cartridge fitted to the inflator head.

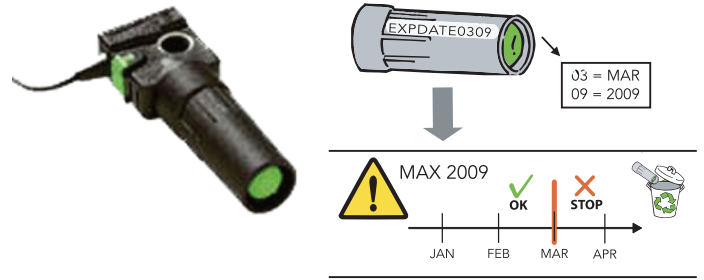

Fig 1. United Molders automatic valve.

6.2 For Automatic models fitted with Halkey Roberts automatic valve with transparent head and water sensing bobbin (Fig 2.)

The Halkey Roberts Bobbin has a lifespan of four years and is printed with the date of manufacture. Calculate when a replacement bobbin is due. There are two different formats for the date. Example 0650, denotes year 2006 on the 50th day. Alternatively Feb19 06HRC, denotes the 19th of February 2006. In recreational use the bobbin must be replaced no later than the third year from its manufacturing date.

- Check if green indicator is showing at base of head. Remove the bobbin by unscrewing the transparent automatic head anti clockwise. Discard bobbin if expiry date (see paragraph above) falls within next 12 months or green indicator at base of transparent head is not visible when armed.

To rearm the Halkey Roberts automatic valve

- Fit new bobbin (the bobbin will only fit one way round).
- Refit transparent head by screwing it clockwise until hand tight.
- Check that the green firing indicators are visible.

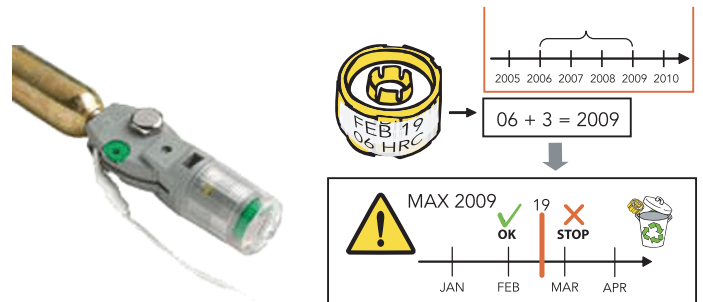

Fig 2. Halkey Roberts automatic valve
The water sensing bobbin is inside the transparent cup

Step 7. Refitting the CO2 cylinder

7.1 Check that

- that CO2 cylinder has passed inspection (Refer Step: 4)
- inflator valve has passed inspection and is rearmed (Refer Step: 5)
- that automatic valve has passed inspection and is rearmed. (Refer Step: 6)

7.2 Hold the unit firmly and screw the CO2 cylinder clockwise into top of the inflator head. Hand tighten until firm.

DO NOT USE ANY TOOLS OR UNDUE FORCE

Note: When replacing with a new CO2 cylinder the new cylinder should be inspected as per step 4. For the piercing cutter to work correctly both the CO2 cylinder and automatic head (when fitted) must be firmly hand tightened onto inflator valve.

Step 8. Record service inspection on your PFD.

8.1 If the PFD has passed all applicable self inspection steps described in steps 1 through 7, using a permanent laundry marker Sign and date the Service inspection label located on the inflation valve side of the PFD lung.

Format for dating a self inspection should be SI-YY-MM (the prefix SI is to indicate self inspection)

For example for a self inspection completed in August 2010 service schedule should show SI-10-08

Step 9. Repack PFD

9.1 Repack the PFD according to model instructions as described in your PFD owners manual. Make sure the manual pull lanyard is not tangled and that the lanyard knob is hanging outside the PFD cover.

Step 10. Certify PFD Inflatable Self Inspection Certificate

10.1. Sign self inspection certificate and record the date that self inspection was completed. It is also recommended that the next inspection due date is noted in space provided and that the signed and dated certificate is placed in boats safety equipment log for future reference.

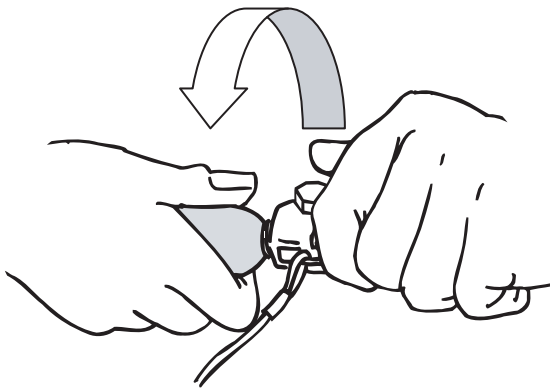

BURKE INFLATABLE PFD SELF INSPECTION CERTIFICATE

Applicable for inflatable PFD's in recreational use only

BEFORE YOU START:

Carefully read 'Burke Inflatable PFD's Instructions for annual self inspection. Record each inspection step as describe in the instructions on this certificate as it is completed. If the PFD or a component of the PFD fails any of the checks listed in steps 1-6 the PFD or the faulty component must be replaced before further use, alternatively the PFD should be sent to an accredited service agent for further inspection.

Under no circumstances must you attempt any repairs yourself.

Product PI No: or Serial No:		Last serviced date or date of purchase if no service.		
Model			YY	MM

Check Status at each step by marking box	PASS	'YES'	Not applicable	'NA'	FAIL	'NO'
--	------	-------	----------------	------	------	------

1.	General Inspection	PASS	FAIL
1.1	Checked cover, closures, straps and operation of buckle		
1.2	Checked retro-reflective tape, lifting becket, operation of whistle and oral inflation tube		
1.3	Checked safety harness and components (if fitted)		

2	Inspection of lung	PASS	FAIL
2.1	Checked lung for abrasion or wear		
2.2	Performed lung leakage test		

3	Inspection of mouth inflation tube and its valve	PASS	FAIL
3.1	Checked operation of mouth inflation tube and valve		

4	Inspection of CO2 cylinder				PASS	FAIL
4.1	Inspected CO2 cylinder for damage or corrosion					
4.2	Check weighed cylinder	Record	GR.WT	Actual weight		

5	Examine operation of Manual valve	PASS	FAIL
5.1	Checked operation of valve and secured new firing indicator clip		

6	Inspection and rearming of automatic valve (Auto Inflate water sensing models only)				PASS	FAIL
6.1	Checked expiry date and that green indicator is in place United Moulders	YY	MM			
6.2	Checked expiry date and that green indicator is in place Halkey Roberts	Expiry date				

7	Refit inspected or new CO2 cylinder (ref: Step 4)		X
----------	---	--	---

8	Sign and date PFD service schedule attached to PFD		X
----------	--	--	---

9	Repack PFD (ref: owners instruction manual supplied with PFD)		X
----------	---	--	---

10	I hereby certify that this PFD has been inspected and serviced in accordance with the Burke Annual self inspection instructions describe in steps 1 though 9.	YY	MM
		Next inspection due	

Name	Signature	Date
Address		

PLEASE RETAIN COMPLETED DOCUMENT UNTIL YOUR NEXT INSPECTION